

**SLOAN**  
FLUSHOMETERS

*Royal*  
Flushometer  
Maintenance Guide

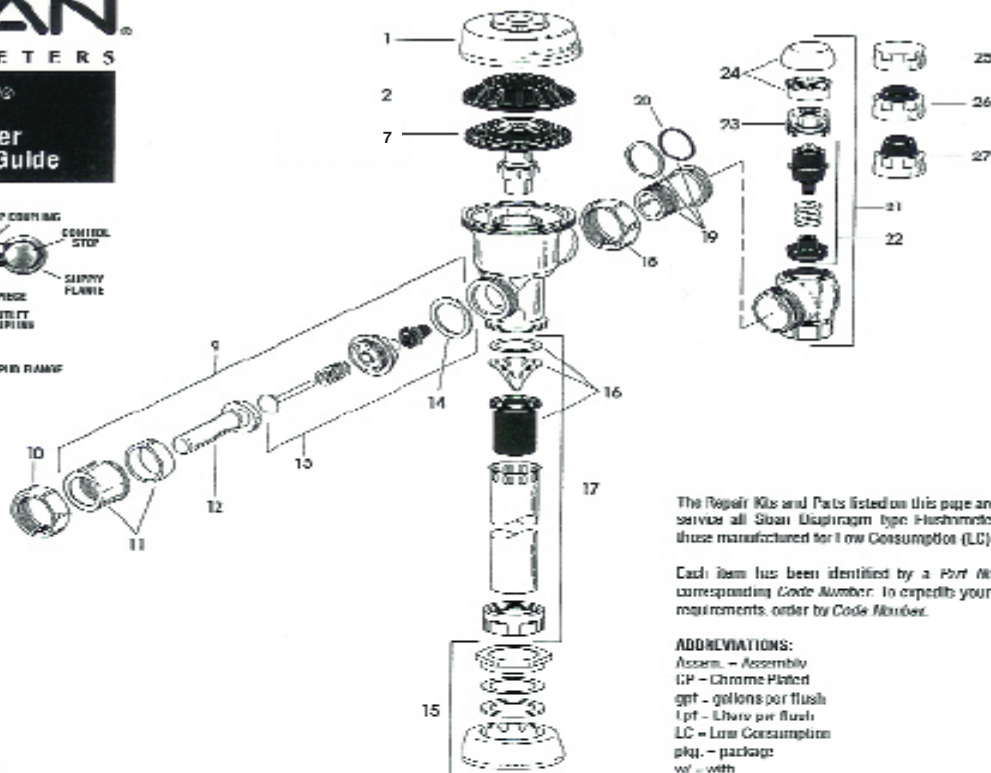
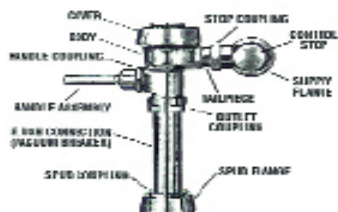

The Repair Kits and Parts listed on this page are designed to service all Sloan Diaphragm type Flushometers, including those manufactured for Low Consumption (LC) usage.

Each item has been identified by a Part Number and a corresponding Code Number. To expedite your replacement requirements, order by Code Number.

**ABBREVIATIONS:**

- Assem. - Assembly
- CP - Chrome Plated
- gpf - gallons per flush
- lpr - liters per flush
- LC - Low Consumption
- pkg. - package
- w/ - with

**PARTS LIST**

- |     |  |          |  |
|-----|--|----------|--|
| 1.  | 0301177  | A-77     | 1" Cover   |
| 2.  | 0301168  | A-71     | Inlet Valve  |
| 2A. | 5301000  | A-19-AC  | Retlet Valve, White (Closed) - 12 per pkg.                                   |
| 2B. | 5301000  | A-19-AD  | Retlet Valve, Black (Unltd) - 12 per pkg.                                    |
| 2C. | 5301211  | A-19-ALC | Retlet Valve, Green (Close/Urinal-LC) - 12 per pkg.                          |
| 2D. | 5301143  | A-19-AL  | Retlet Valve, Blue (1 liter Close) - 12 per pkg.                             |
| 4.  | 5301111  | A-78-A   | Use - for all inside parts kits - 12 per pkg.                                |
| 5.  | 5301108  | A-75B-A  | Diaphragm - for all Inside Parts Kits - 12 per pkg.                          |
| 6A. | 5301238  | A-78C-A  | Guide Assem., 4.5 gpf/17.0 lpr Closet & 1.5 gpf/5.7 lpr Urinal - 12 per pkg. |
| 6B. | 5301032  | A-75a-A  | Guide Assem., 3.5 gpf/13.2 lpr Closet - 12 per pkg.                          |
| 6C. | 5301031  | A-75T-A  | Guide Assem., 1.5 gpf/5.0 lpr Urinal - 12 per pkg.                           |
| 6D. | 5301150  | A-75B-A  | Guide Assem., 1.0 gpf/3.8 lpr Urinal - 12 per pkg.                           |
| 6E. | 5301157  | A-75T-A  | Guide Assem., 0.5 gpf/1.9 lpr Urinal - 12 per pkg.                           |
| 7.  | <b>SEE THE INSIDE PARTS KITS CHART ON THE REVERSE SIDE</b> |          |  |
| 9.  | 0301390  | A-73-A   | CP Handicap Handle Assem. (A II A Compliant) (shown)                         |
| 10. | 5302279  | A-32-A   | CP Handle Assem. (not shown) - 6 per pkg.                                    |
| 11. | 0301080  | A-6      | CP Handle Coupling   |
| 12. | 0301081  | A-7-A    | CP Socket Assem.   |
| 13. | 0301381  | A-74-A   | CP Handicap Handle Grip (A.I.I.A. Compliant) (shown)                         |
| 14. | 5302274  | A-37     | CP Handle Grip (not shown) - 12 per pkg.                                     |
| 15. | 5301306  | A-51-A   | Handle Repair Kit  |
| 16. | 5301131  | A-31     | Handle Couplet - 48 per pkg.   |
| 17. | 0301125  | A-5-A    | 3/4" CP Spud Coupling Assem.   |
|     | 0305140  | A-5-A    | 1 1/2" CP Spud Coupling Assem.   |
|     | 0305146  | A-5-A    | 1 1/2" CP Spud Coupling Assem.   |
| 18. | 5301187  | A-55T-A  | Vacuum Breaker Repair Kit  |
| 19. | 0306034  | A-600-A1 | 3/4" x 9" CP Vacuum Breaker  |
|     | 0306036  | A-600-A1 | 1 1/2" x 9" CP Vacuum Breaker  |
|     | 0306037  | A-600-A1 | 1 1/2" x 8" CP Vacuum Breaker  |
| 20. | 0306076  | A-55P    | CP Stop Coupling   |
| 21. | 0306011  | A-55T-A  | CP Adjustable Tailpiece 2 1/4" long  |
| 22. | 0306015  | A-55P    | CP Ring - 24 per pkg.  |

- |     |         |          |   |
|-----|---------|----------|---|
| 21. | 0306081 | A-700-A  | 1" Screwdriver/Bak-Chek® Stop CP - complete   |
|     | 0306084 | A-700-A  | 3/4" Screwdriver/Bak-Chek® Stop CP - complete |
| 22. | 0306083 | A-541-A  | Control Stop Repair Kit                       |
|     | 0306085 | A-543-A  | Control Stop Repair Kit**                     |
| 23. | 0306012 | A-622    | CP Hammer*                                    |
|     | 0306013 | A-627    | CP Hammer**                                   |
| 24. | 0306791 | A-1010-A | Vandal Resistant Control Stop Cap Assem.*     |
|     | 0306790 | A-1009-A | Vandal Resistant Control Stop Cap Assem.**    |
| 25. | 0008840 | A-573    | Control Stop Cap CP*                          |
|     | 0008848 | A-582    | Control Stop Cap CP**                         |
| 26. | 0308888 | A-574    | Control Stop Cap w/Hammer*                    |
| 27. | 0308887 | A-578    | Control Stop Cap w/stranded Bumper*           |

\* for use w/A-100-A 1" & 3/4" and A-600-A 1" Screwdriver Bak-Chek® Control Stops  
\*\* for use w/A-600-A 3/4" Screwdriver Bak-Chek® Control Stops

PARTS LIST FOR INSIDE PARTS KITS		
Includes items 7-13-16 & 20		
CODE NO.	KIT NO.	DESCRIPTION
5301048	A-1001-A	Retlet Kit (1.5 gpf/5.7 lpr) Closet/Service Sink
5301049	A-1002-A	Retlet Kit (1.5 gpf/5.7 lpr) Urinal
5301047	A-1003-A	Retlet Kit (1.5 gpf/5.7 lpr) Close
5301053	A-1004-A	Retlet Kit (1.5 gpf/5.0 lpr) LC Closet
5301054	A-1005-A	Retlet Kit (1.5 gpf/3.8 lpr) LC Urinal
5301050	A-1011-A	Retlet Kit (0.5 gpf/1.9 lpr) Urinal
5301051	A-1012-A	Retlet Kit (0.5 gpf/1.9 lpr) Close
WASHER SET		
5301048	A-150-A	Washer Set - Includes: 4, 5, 8 & 14

This information is provided for informational purposes only. Sloan reserves the right to change without notice.

7. INSIDE PARTS KITS						
A	B	C	D	E	F	G
<b>A-36-A</b> 5301000 4.5 gpf/17.0 lpr CLOSET	<b>A-37-A</b> 5301087 1.5 gpf/5.7 lpr URINAL	<b>A-38-A</b> 5301038 3.5 gpf/13.2 lpr CLOSET	<b>A-41-A</b> 5301041 1.5 gpf/5.0 lpr CLOSET	<b>A-42-A</b> 5301044 1.0 gpf/3.8 lpr URINAL	<b>A-43-A</b> 5301051 0.5 gpf/1.9 lpr URINAL	<b>A-44-A</b> 5301054 2.4 gpf/9.0 lpr CLOSET