



1510 Stock Series



Series 1535



Series 1531



Series 1522



Series 80 In-Line Pump



Series 1531



To size your pump, please provide the following:

- Model # of ID plate
- Horsepower
- RPM
- Voltage and Phase
- Pipe size inlet and outlet
- Base mounted or close coupled
- GPM and FT of head
- Fluid being pumped
- Bronze or iron
- Casting # off volute
- Serial #

3-Piece Oil-Lubricated Booster Pumps

Powerful Bell & Gossett motor provides years of trouble-free service.

- Sleeve bearing, oil lubricated motor has replaceable resilient motor mounts
- Unique spring design coupler for quiet operation
- Mechanical seal designed to withstand wide range of water temperatures, pressures, additives and dissolved solids
- Long bronze sleeve bearings maintain exact shaft alignment, provide constant circulation of oil over bearing surfaces, 115 volt, 1 phase



75-150, PR, HV, PD Series



Series 3530



Series CT



Series 90

Wet Rotor Circulator Pump

Highest starting torque in the industry!

- DuraGlide™ Bearing System assures whisper-quiet, maintenance-free operation-eliminates seasonal freeze-ups
- High-efficiency closed impeller design
- Carbon bearings, diamond-like ceramic shaft and generous clearances for more resistance to lime, chloride and oxide build-up
- Self-cleaning particle shield protects shaft and bearings from system start-up debris



Series 100NFI

VNS#	Gallons Per Minute (GPM)							Best Efficiency GPM @ Head Fit
	3GPM	5GPM	8GPM	10GPM.	15GPM	18GPM	20GPM	
BG010	13"	12'	10'	8'	5'	5'	2'	10 GPM @ 8'

HP	Pump Body	Full-Load AMPS	Face To Face (IN.)	Dimensions (In)		Inlet & Outlet	B&G Model	VNS#	Ship Wt
				W	L				
1/25	Cast Iron	1.75	6 3/8	4 7/8	5 5/8	Flanged(*)	NRF-22	BG010	9.5

(*) Use 3/4, 1, 1 1/4, 1 1/2" flanges sold separately. Gaskets, nuts and bolts supplied.

Circulating Pump Coupler

Fits Pump	Size	Shaft Material	Coupling	Manufacturer's Cross Reference			Ship Wt
				Bell & Gossett	Armstrong	VNS#	
4RD16, 4RD17	1/2" x 1/2"	Steel	189110	806026-002	BG581	0.2	
4RC93	Heavier Version	Cast Steel	118705		BG578	0.2	



NRF-22

BELL & GOSSET ITT
FLUID HANDLING DIVISION

**B & G BOOSTERS
REPLACEMENT PARTS**

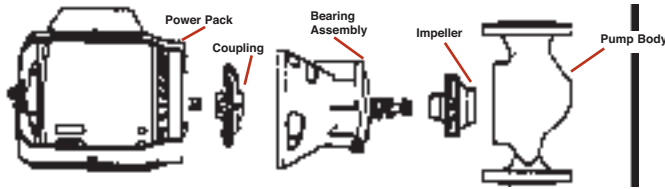

	VNS#	IMPELLERS	
		Series 100 Booster	
189132	BG685	P3500S-0311Z	
118431	BG651	PB4Z-335	
118435	BG654	PB2Z-635	
118436	BG655	PB2Z-835	
118440	BG657	PB4Z-1235	2 1/2" & LD 3"
118439	BG656	PB3Z-1235	HD 3"
		BEARINGS ASSEMBLIES	
		IRON	
118844	BG537	PAZ-3351	
185012	BG539	1510 Series	
186865	BG550	Series 60/1522	
189105	BG557	P3Z-12351, PB4Z-12351 (189106)	
186863	BG548	PD2Z-12351-118478, 118480 (186864)	
185260	BG544	PD26Z-12351	
		BRONZE	
189034	BG551	PB1Z-3351	
189163	BG563	P10Z-435, 189103, 189102, 189101	
189162	BG562	189100, 189104	
189166	BG565	189136	
185262	BG546	PD2Z-12351	
189165	BG564	2" BNFI, HVBNFI, 189120, 189122	
186660	BG547	PHD2Z-12351	Universal
185011	BG538	PWBFZ-526	1510
185014	BG541	PB3Z-626	1510
		BOOSTER MOTORS	
111034	BG733	(P115Z-3)	1/12 H.P.
111031	BG734	(P115Z-4) (111036)	1/8 H.P.
111040	BG735	P115Z-10	1/4 H.P.
111044	BG738		1/2 H.P.
		BOOSTER SEALS	
118681	BG818	#7	Seal-Booster Seal
186499	BG820	#2	Seal-Booster Seal
168862	BG825	#1	Seal 1510 or Universal
186543	BG821	#8	Seal 1510 or Universal
		COUPLERS	
118473	BG576	(PDZ-12291)	
118705	BG578	(PZ-4291)	
118708	BG579	(P2Z-4291)	
118709	BG580	(P4Z-4291)	
118723	BG582	(P115Z-12)	
		MISC. B & G ITEMS	
L23401	BG801	Oil Tube Pump Lub.	
118223	BG794	1 Set Motor Mounts	
118228	BG796	1 Set Motor Mounts	

**Line of Standard Relief,
Reducing and
Self-filling Valves**

Dual Unit Valve 1/2"

Reducing Valve Set @ 12 PSIG
And Relief Valve Set @ 30 PSIG

8	VNS# BG187	*110199	
8TU		*110200	



Dual Unit Valves—With Fast Fill Feature

Reducing Valve Set @ 12 PSIG And Relief Valve Set at 30#

F-3	VNS# BG188	Brass	*110197
F-3TU		Brass	*110198
F-8		Iron	*110201
F-8TU		Iron	*110202

30 PSIG A.S.M.E. Relief Valves

790	790,000 BTU/HR	BG394	3/4"
1170	1,700,000 BTU/HR	BG402	1"
3301	3,301,000 BTU/HR	BG409	1 1/2"
4100	4,100,000 BTU/HR	BG413	2"



Pressure Reducing Valves

Set @ 45 PSIG High Pressure

1/2 NPT 6	BG376	*110194
3/4 NPT 7	BG377	*110194

Pressure Reducing Valves

Set @ 12 PSIG High Pressure

1/2 NPT B-38	BG383	*110190
1/2 NPT B-38TU	BG386	*110191
3/4 NPT B7-12	BG384	*110196



Pressure Reducing Valves

With Fast Fill Feature—Set @ 12 PSIG

1/2 NPT	FB-38	*110190
	FB-38TU	*110193



Air Valves For Hot Water Heatings Systems



No. 7 Automatic Air Vent
1/8" 75# Female VNS#...MO007

No. 67 Automatic
Air Eliminator
1/8" 35# Male VNS#...MO067

17 Sr. Automatic Hot
Water Air Valves
1/8" 30# Male VNS#...BG001



B & G AIRTROL®

B & G Airtrol® Systems properly control air in closed hydronic systems of all sizes. Prevent accumulation of air; prevent noise caused by entrained air in piping.

**AIRTROL® FITTINGS
TANK FITTINGS**

Model No.	VNS#	Part No.
ATF-9	BG192	*112008
ATF-12	BG193	*112010
ATF-16	BG194	*112011
ATF-20	BG195	*112026
ATF-24	BG196	*112013
ATFL	BG197	*112014



Airtrol Tank Fitting

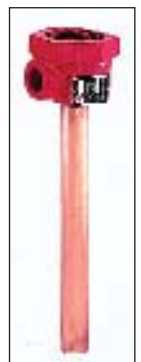

Airtrol Boiler Fitting

IAS In-Line Air Separators

Model No.	Part No.	Size Inches
IAS-1	*112095	1"
IAS-1 1/4	*112096	1 1/4"
IAS-1 1/2	*112097	1 1/2"
IAS-2	*112098	2"
IAS-2 1/2	*112099	2 1/2"
IAS-3	*112100	3"

